



CUQUI





7°PM-1-188-20



## DESCRIPTION

CUQUI must be the best Sunseeker Predator 62 available. She is in her second private ownership. Both of her owners are experienced yacht owners and have spared no expense with her maintenance. Recent upgrades include new batteries, new water maker, new inverter and new Sonos sound system. Yearly maintenance includes anti fouling, polish & wax and mechanical services. CUQUI is the perfect Mediterranean cruising yacht.

CUQUI Sunseeker Predator 62 is truly well equipped. It is hard to believe that anything was left off when she was commissioned. Hydraulic platform, hydraulic gangway, opening hard top roof, electric canopy for aft deck, bow and stern thrusters, upgraded windlass, stern mooring winches, water maker, upgraded generator, underwater lights and aft facing camera to name just a few of her options.

Viewing is highly recommended and available by appointment. Do not hesitate to contact us to find out more about this special yacht or to arrange your viewing.

## NOTABLE FEATURES

- Private ownership and use since new – only two owners
- EU VAT paid and Matriculation tax paid for Spanish residents
- Twin MAN V8 900 HP engines
- Bow and stern thrusters
- Large Kohler generator and recently installed Idromar water maker
- Hydraulic platform for tender as well as storage garage for equipment
- Opening hard top and electric sun shade for aft deck
- Hydraulic gangway for boarding
- Teak laid cockpit and platform
- 72000 BTU air conditioning throughout
- Mooring winches at stern

## GENERAL

Price	<b>€ SOLD</b>
EU Tax	VAT Paid
Year Built	2007
Location	Palma de Mallorca
Builder	Sunseeker, UK
LOA	19.61 metres
Beam	5.00 metres
Draft	1.55 metres
Displ.	29000 kg







## DESIGN & CONSTRUCTION

Built by Sunseeker Yachts in Poole, UK

Deep Vee hull

Hand-laid GRP

Isophthalic polyester skin coat

Stitched multi-axial single-skin bottom

Hull stiffened with longitudinal stringers supported by transverse bulkheads and floors

Hydraulic platform for tender

Hydraulic gangway

Teak laid cockpit and platform

Opening hard top

## EXTERIOR

Hydraulic platform for tender

Garage storage area for toys and equipment

Teak laid cockpit and platform

Opening hard top roof

Sunbathing area on foredeck with reclining back rests

Solid stainless steel guardrail along both side decks for security moving around

L-shaped seating area in aft cockpit

Varnished cockpit table

Wet bar with ice maker, grill and sink

Under water lights from Aqualuma

Stern camera

Cockpit speakers

## INTERIOR

Satin cherry woodwork finish throughout with cream leather upholstery

Teak floor in deck saloon

Desert textured carpets on lower deck and in cabins

72000 BTU reverse cycle air conditioning throughout with separate shore power line

- Each cabin has an individual thermostatic control

Electric freshwater flush WCs throughout

Sonos music system

Main deck:

- Spacious deck saloon with 360-degree views
- Large seating area to starboard with table on electric leg
- Settee to port
- TV to port
- Helm station and navigation area with all controls
- Besenzoni helm seat with forward facing sofa at helm station
- Opening hard top roof above forward section of the deck saloon
- Opening window to starboard next to helm seat

Lower deck:

- Well equipped galley with full height fridge/freezer and Corian work top
- Dinette with C-shaped seating to starboard and TV
- Full beam master cabin midships with en suite bathroom, settee and vanity desk
- VIP cabin forward with double bed, ample storage and en suite access to forward bathroom (also used by bunk cabin and as a day heads via separate access)
- Bunk cabin to starboard with full height wardrobe

















# SYSTEMS & INVENTORY

## PROPULSION

Twin MAN V8 900 HP diesel engines

- Showing only 830 hours run at November 2024
- Shaft drive

Sound insulation

Total fuel capacity: 3000 litres

Fuel shut off valves

Automatic fire extinguishing system in engine room

Bow thruster: Lewmar 250TT8.0 24V with independent battery bank

Stern thruster: Lewmar 250TT8.0 24V

## NAVIGATION

Hydraulic steering

Raystar 125 GPS Diff receiver

Raymarine 4kW 48" open scanner in lieu of std

Raymarine E120 12" chart plotter

Raymarine Ray 240E VHF

Raymarine ST6002+ autopilot

Raymarine ST60 MFD

## SAFETY

Please note that equipment such as life rafts, fire extinguishers and flares require regular servicing and/or renewal. If such equipment is left on board as part of the sale, the buyer should ensure that the equipment is suited to their usage plans. Assume that service or replacement will be required after purchase to ensure that all safety equipment complies with any flagging or personal requirements.

## ELECTRICAL

12 / 24 / 220V 50 Hz electrical system

13kW Kohler generator

24V/3000W inverter

12V and 24V alternators on engines

Battery chargers

Batteries all replaced recently

12V and 220V outlets

## GROUND TACKLE & MOORING

Hydraulic platform for tender with tender chocks

Hydraulic gangway

Electric anchor windlass with capstan (upgraded from standard)

Stainless steel Ultramarine anchor

12mm stainless steel chain

Two Lewmar C3 stainless steel stern mooring winches

Additional pair 10" mooring cleats fitted to aft edge of the hull band below hull/deck joint

Mooring lines and fenders

## WATER

Fresh Water:

- Water maker Idromar 130 litres/hour
- High pressure hot and cold water circuit
- Hot and cold water manifold
- Hot water boiler
- Total freshwater capacity: 700 litres
- Cockpit shower at transom
- Fresh water dock inlet

Bilge Pumps:

- Electric bilge pump
- Manual bilge pump

## COVERS & CUSHIONS

Foredeck sun bathing cushions

Aft cockpit cushions

Electric canopy for aft cockpit

Sun umbrella for aft platform

Cover for large forward facing deck saloon windows

Cover for deck saloon cabinet most exposed to UV

Cover for helm station to protect from UV damage

Covers for exterior cushions







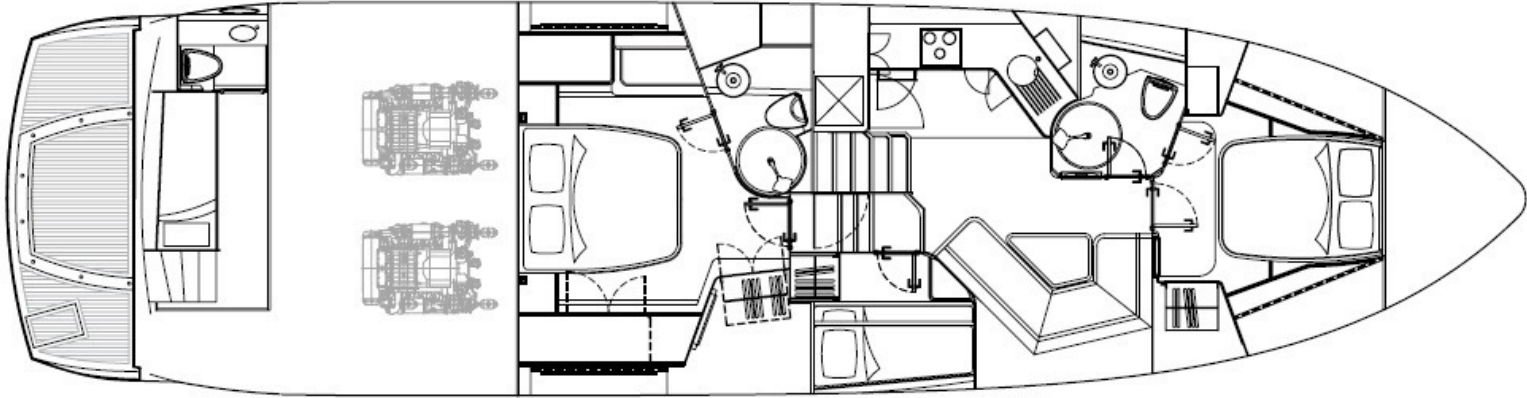
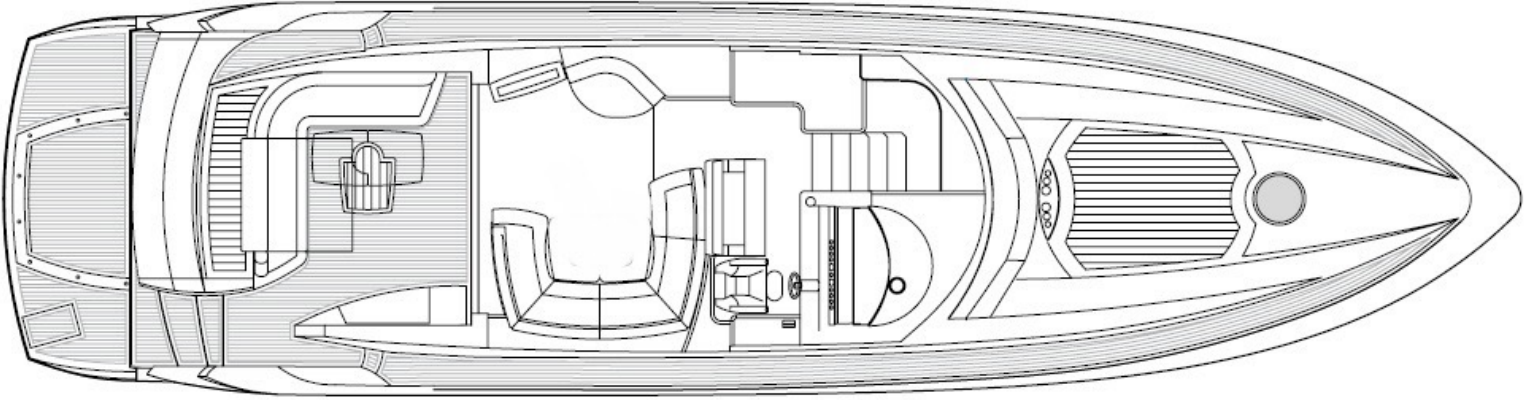
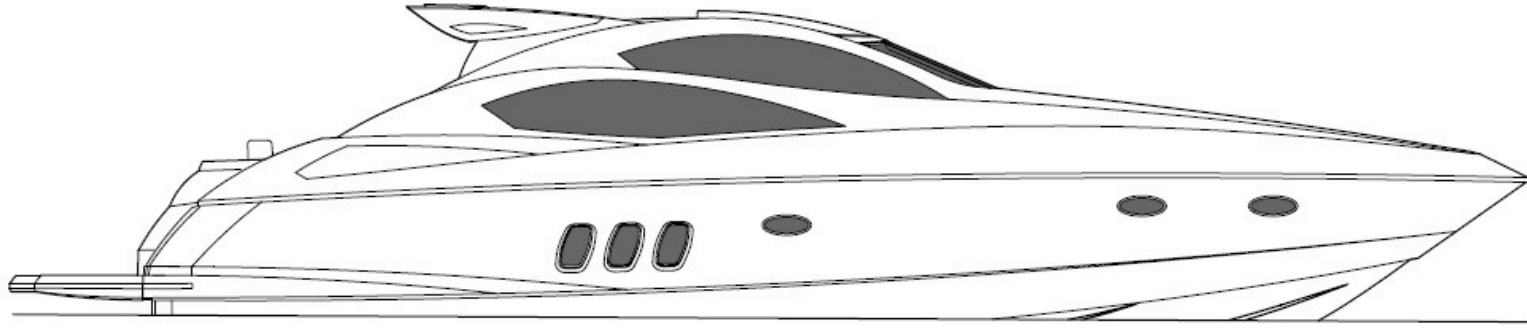



**Tristan Abery**

E. [tristan@aberyyachts.com](mailto:tristan@aberyyachts.com)

M. +44 7766 130909

M. +376 62 20 45

**Stephen Abery**

E. [stephen@aberyyachts.com](mailto:stephen@aberyyachts.com)

M. +44 7545 235555

M. +376 35 75 55



We are acting as brokers for the owner of the Vessel. The owner has provided details of the Vessel and it's inventory and these details are based on that information. The accuracy of these details cannot be guaranteed nor do they constitute part of any contract. A prospective buyer is strongly advised to have the vessel fully surveyed by a qualified marine surveyor and to verify the particulars prior to the survey.

The Vendor is not selling in the course of business unless otherwise stated. This vessel is offered subject to prior sale, price change or withdrawal without notice.