







LAKSHMI must be one of if not the best **Sunseeker Predator 60** for sale on the market. Her current owner has owned her almost since new and the continuity of maintenance is evident throughout. She has only seen private and careful use in her life resulting in low engine hours of approximately 650 per engine. She has twin VOLVO IPS 1200 engines. The IPS ensures ease of handling as well as efficiency and the powerful engines mean she can reach speeds of close to 40 knots. LAKSHMI has a spacious interior with a generous full beam master suite with large modern hull windows, a comfortable VIP cabin forward and twin cabins amidships. She is in great condition for her age, immediately available and fully EU VAT paid.

LAKSHMI has continually been updated and upgraded since being launched, the latest major additions being a new Williams 395 Jet Tender and two new Raymarine Axiom 16" display screens in 2023. She is extremely well equipped including popular and expensive options such as the hydraulic high-low platform, hydraulic gangway, opening hardtop, water maker, generator, reverse cycle air conditioning throughout and under water lights.

All equipment on board is included with the sale. Viewing of this special yacht is highly recommended and available at short notice by appointment.

## GENERAL

Price € 700.000  
Tax EU VAT paid

Location Lefkas, Greece  
Year Built 2011  
Flag German  
Builder Sunseeker, UK

LOA 19.38 metres  
Beam 5.10 metres  
Draft 1.52 metres  
Light Displ. 32000 kgs

Fuel 3000 litres  
Water 700 litres



## NOTABLE FEATURES

- Private ownership and use since new – same ownership since 2013
- EU VAT paid
- Twin VOLVO IPS 1200 diesel engines – top speed of close to 40 knots
- Bow thruster for added manoeuvrability
- Kohler generator and water maker for autonomous cruising
- Hydraulic platform for new Williams 395 tender
- Opening hard top and electric sunshade for aft deck
- Hydraulic gangway for boarding
- Teak laid cockpit, decks and platform
- Reverse cycle air conditioning throughout
- Mooring winches at stern
- Stainless steel anchor and rear facing camera





## EXTERIOR

- Hydraulic platform for tender
- Hydraulic gangway
- Garage storage area for toys and equipment
- Teak laid cockpit and platform
- Opening hard top roof
- Sunbathing area on foredeck
- Solid stainless steel guardrail along both side decks for security moving around
- Huge cockpit with two L-shaped seating areas and adjustable folding teak table
- Wet bar with ice maker, grill and sink
- Forward facing bench to port and navigation area and helm seat to starboard
- Under water lights
- Cockpit speakers
- Rear facing camera









## INTERIOR & LAYOUT

High gloss finish throughout with cream leather upholstery  
Textured carpets in saloon and in cabins  
Reverse cycle air conditioning throughout with separate shore power line

- Each cabin has an individual thermostatic control
- Electric freshwater flush WCs throughout  
Fusion music system

### Saloon:

- Large and deep sofa to starboard facing a wall mounted flatscreen TV
- L-shaped galley to port amidships equipped with hob, microwave oven, two fridges, dish washer and stainless steel sink with mixer tap  
Opening portholes on either side of the saloon for natural ventilation

### Accommodation:

- Full beam master cabin midships with en suite bathroom, sofa and desk as well as two large hull windows with opening sections
- VIP cabin forward with double bed, ample storage and en suite access to forward bathroom (also used by bunk cabin and as a day heads via separate access)
- Twin cabin to starboard with full height wardrobe









# SYSTEMS

## PROPULSION

Twin VOLVO IPS 1200 diesel engines  
- Showing only 650 hours run at November 2025  
- IPS drive  
Sound insulation  
Total fuel capacity: 3000 litres  
Fuel shut off valves  
Automatic fire extinguishing system in engine room  
Bow thruster Sliepnier in tunnel

# INVENTORY

## NAVIGATION & COMMUNICATION

Hydraulic steering  
Rear facing camera  
Navigation lights  
Two Raymarine Axiom Plotter 2 PRO 16s 16" screens  
(new in 2023)  
KVH with M7 satellite system  
Raymarine VHF  
Raymarine autopilot

## ELECTRICAL

12 / 24 / 220V 50 Hz electrical system  
Kohler generator showing approx. 2000 hours run at November 2025  
Inverter  
12V and 24V alternators on engines  
Battery chargers  
Domestic batteries 24V  
Engine start batteries 24V  
Generator start battery 12V  
12V and 220V outlets

## GROUND TACKLE & MOORING

Hydraulic platform for tender with tender chocks  
Hydraulic gangway  
Electric anchor windlass with capstan (upgraded from standard)  
Stainless steel anchor and spare Delta anchor in engine compartment  
120m 12mm chain  
Two Lewmar C3 stainless steel stern mooring winches  
Mooring lines and fenders

## WATER

Fresh Water:  
- Water maker: GRO Seafarer SFC700  
- High pressure hot and cold water circuit  
- Hot and cold water manifold  
- Hot water boiler  
- Total freshwater capacity: 700 litres  
- Cockpit shower at transom  
- Fresh water dock inlet  
Black water:  
- Total capacity: 185 litres  
Bilge Pumps:  
- Electric bilge pump  
- Manual bilge pump

## COVERS & CUSHIONS

Foredeck sun bathing cushions  
Cockpit cushions for seating and sunbathing area  
Electric canopy for aft cockpit  
Cover for helm stations  
Mesh covers for windows





# LAYOUT – SUNSEEKER PREDATOR 60

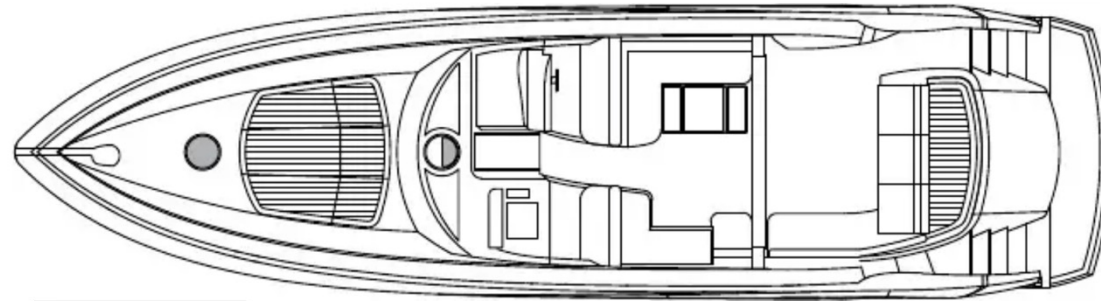

**Main deck option**  
Shown with optional enclosed  
cockpit arrangement

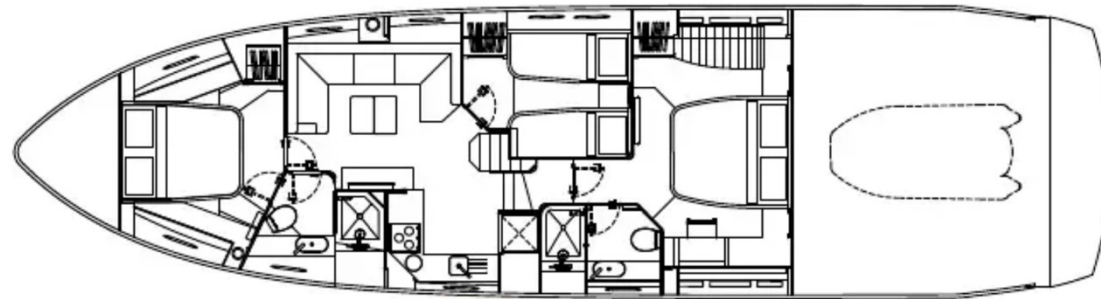

**Lower deck**  
Shown with tender size to suit open  
cockpit arrangement

**Tristan Abery**

E. [tristan@aberyyachts.com](mailto:tristan@aberyyachts.com)

M. +44 7766 130909

M. +376 62 20 45

**Stephen Abery**

E. [stephen@aberyyachts.com](mailto:stephen@aberyyachts.com)

M. +44 7545 235555

M. +376 35 75 55



We are acting as brokers for the owner of the Vessel. The owner has provided details of the Vessel and it's inventory and these details are based on that information. The accuracy of these details cannot be guaranteed nor do they constitute part of any contract. A prospective buyer is strongly advised to have the vessel fully surveyed by a qualified marine surveyor and to verify the particulars prior to the survey.

The Vendor is not selling in the course of business unless otherwise stated. This vessel is offered subject to prior sale, price change or withdrawal without notice.