



CNB 76 – “ZAMPA”

This CNB 76 for sale is #4 of the successful and popular series. She has been in private ownership since new. She is well equipped with all the expected options and comforts on board including an all-furling rig with in-mast mainsail (with full vertical battens) and a hydraulic gangway. This CNB 76 has a customised interior layout with an office area in the saloon and the master cabin benefits from a large double on the centre-line facing aft. She is offered for sale ex VAT but she remains under a French lease which can be transferred to a qualified buyer giving VAT paid status in the EU.

The CNB 76 is a luxurious, spacious cruiser built by CNB in France. Modern, elegant design by Philippe Briand with a wide stern, chines, two rudder blades and vertical bow. The deck saloon ends behind the mast and foredeck is completely flush. This gives the CNB 76 her sleek profile and elegant appearance. With a large, longitudinal tender garage, the fantastic, bright deck saloon, a clever four-cabin layout with owner's cabin forward and the spacious asymmetrical cockpit the CNB 76 was an extremely popular model. A very clever arrangement of the galley and crew area with direct cockpit access leaves the owner and their guests completely undisturbed and detached from the functional areas on board.

Price	€ SOLD	Flag	French
Tax	Under Leasing	Naval Architect	Philippe Briand
Location	Cap d'Agde, France	Builder	CNB, France
Year	2015		

NOTABLE FEATURES

- Light grey gelcoat hull finish
- Hydraulic in-mast furling rig – painted white
- Almost unused Incidence DFi membrane sails
- Teak laid cockpit, side decks and foredeck with grey caulking
- Bow and stern thrusters for easy handling at close quarters
- Generator and water maker for autonomous cruising
- Fantastic master cabin forward, bed on centreline facing aft
- Two guest en-suites mid-ships and a double aft for crew or guests
- Custom saloon layout with office area to starboard
- Forepeak equipped with single berth (a second can be installed)
- Full complement of domestic equipment on board including dishwasher and washer/dryer
- Hydraulic Opacmare gangway 2.90m
- Custom helm seats
- Underwater lights
- Longitudinal 3.45m tender garage

DIMENSIONS

LOA	23.17 metres	LWL	21.98 metres
Beam	6.10 metres	Displacement (unladen)	45 tons
Draft	3.00 metres		

*all measurements are approximate and manufacturer supplied

CONSTRUCTION

The hull and structural bulkheads are made of vacuum infused PVC foam / glass / carbon and resin sandwich
Watertight bulkheads forward and aft – bulkheads are laminated and/or bonded to hull and deck
Deck made of composite/PVC foam sandwich is vacuum infused
Deck beams are carbon fibre reinforced
Keel fitted to the hull with s/s bolts
Twin hanging rudders with vacuum infused rudder blades, s/s rudder stocks and JP3 bearings
Vectran cable on aluminium quadrant
Opening transom/swim platform giving access to longitudinal 3.45m tender garage
Light grey gelcoat finish on hull
Underwater lights

EXTERIOR

Teak laid cockpit, side decks, foredeck and bathing platform with grey caulking
Cockpit

- Comfortable aft cockpit split into two zones, sailing aft and leisure forward
- Each helm position with large console for navigation equipment
- Teak cockpit table with folding leaves and electric telescopic leg with infill cushion to covert to large sunbathing area
- Cockpit fridge
- Hot and cold shower

Large flush foredeck

Flush deck Lewmar hatches

Spreader lights

Spacious lockers beneath aft deck to port and starboard

DECK GEAR

Upgraded Winch Package:

- 2 x Harken 80.2 STEP primary electric winches
- 2 x Harken 70.2 STEP secondary electric winches
- 1 x Harken 70.3 STEP mainsail electric winch (three gears)
- 1 x Harken 70.3 STEP electric winch at mast step (three gears)
- 1 x Harken 70.3 STEP electric winch at mast step (two gears)

Harken genoa sheet tracks and cars

Harken turning blocks

Harken jammers

Recessed self-tacking track for staysail

INTERIOR & ACCOMMODATION

Sleeps eight in four cabins plus single berth crew cabin in forepeak

Sirocco ambiance interior – honey coloured oak woodwork and floors with beige carpets

Air conditioning: Webasto 72000BTU

- Two compressors
- Chilled water loop throughout the vessel
- Each cabin fitted with individual thermostatic control

24V lighting throughout

Direct and indirect lighting throughout

Saloon

- Semi raised saloon with panoramic views
- To port: large dining table with two-part table and U-shaped seating, table can be used as dining table or coffee table with electric telescopic legs
- To starboard: custom large chart table/office area
- Electric blinds for coachroof windows

Guest Accommodation

- Master cabin located forward with aft facing centre-line island double bed, ensuite bathroom with towel heater, vanity desk, safe and abundant storage
- VIP cabin to port midships with system to convert into twin, en suite bathroom with towel heater and storage
- Bunk cabin to starboard midships with lower bunk extendable into double, en suite bathroom and storage, bathroom can also be accessed as a day bathroom from the corridor
- Double cabin aft to port with en suite bathroom and storage
- Lee cloths fitted to all berths
- All bathrooms with Corian countertops and electric freshwater flush toilets

Crew

- Access through foredeck hatch
- Fixed single bed (possible to install additional bunk if required)
- Toilet
- Air conditioning outlet
- Storage

Machine room

- Engine, generator, watermaker, air conditioning compressors, water heater and other systems installed in sound proofed room underneath the saloon floor for balance
- Fuel and water tanks are mounted either side for stability and to lower centre of gravity

GALLEY & DOMESTIC EQUIPMENT

Galley located aft to starboard with breakfast bar area, direct access to cockpit via opening hatch with recessed ladder and abundant overhead and under counter storage

Corian worktop

Stainless steel double sink with mixer tap

Grohe water purification system

Miele gimballed four-burner induction stove and oven

Full height fridge (231 litres)

Freezer (140 litres)

Fridge (130 litres)

Cockpit fridge

Ice maker in saloon

Wine fridge – 35 bottle capacity

Miele dishwasher

Miele washer/dryer

PROPULSION

VOLVO D4 180 HP Diesel Engine

- Showing 1800 hours run at February 2025, very low hours for the model
- 2.78:1 VOLVO gearbox
- Stainless steel (F16PH) 60mm shaft
- Bronze P-bucket
- Rope cutter
- Varifold four-blade folding propeller
- 24V 80A alternator
- 12V alternator
- EVC system with electronic throttle at both helm positions

Sound insulation

Retractable bow thruster:

- Side Power SR210/250 24V
- Dedicated battery bank

Retractable stern thruster:

- Side Power SR210/250 24V
- Dedicated battery bank

Fuel:

- Total capacity: 2500 litres
- In two aluminium tanks
- Diesel pre filters

ELECTRICAL SYSTEM

12/24/220V 50Hz system with EU sockets

Generator: Onan 17.5kW

- Showing 2700 hours run at February 2025, very low hours for the model

Batteries:

- Domestic battery bank – Gel 24V/880Ah (new in 2023)
- Start batteries – AGM 12V/150Ah (new in 2023)
- Bow thruster battery pack – AGM 24V/150Ah (new in 2023)
- Stern thruster battery pack – AGM 24V/150Ah (new in 2023)

Inverter: 24/230V 4500W

Charging:

- 24V 100A domestic charger
- 24V 100A domestic charger
- 24V 40A bow thruster charger
- 24V 40A stern thruster charger
- 24V 80A alternator
- 12V alternator

Double 50Ah shore power connection (domestic, air conditioning)

WATER SYSTEM

Fresh Water:

- Water maker: Sea Recovery Aquamatic 280 litres/hour
- Hot and cold pressurised system throughout
- 100 litre water heater – 230V and heat exchanger from main engine
- Fresh water shore inlet
- Cockpit shower
- Deck wash at anchor with fresh/sea water changeover
- Total capacity: 1500 litres
- In two stainless steel tanks located in the centre of the boat under the saloon

Black Water:

- Each toilet has an independent tank
- Evacuation by gravity

Grey Water:

- Two 100 litre holding tanks
- Automatic pump out by 24V pump

Bilge Pumps

- Manual bilge pump
- Electric bilge pumps

RIG

Deck stepped 9/10ths fractional rig

Hall Spars aluminium furling mast – painted white

Rod standing rigging

Hall Spars carbon fibre Park Avenue boom with hydraulic outhaul – painted white

Hydraulic in-mast furling for mainsail

Genoa with manual furling system

Fixed inner forestay with manual furling system

Integrated track with traveller for staysail

Hydraulic boom vang, backstay and halyard tensioners

Running backstays

Gennaker gear including gennaker halyard, spinnaker halyard and 2:1 Code 0 halyard

SAILS

Hardly used

Incidence DFi mainsail with full vertical battens (2023)

Incidence DFi furling genoa (2023)

Incidence DFi furling staysail (2023)

NAVIGATION

Raymarine Axiom XL 19 multifunction display at chart table
Two Raymarine Axiom Pro 9 multifunction displays – one at each helm
Two Raymarine i70 multi displays with transducers for log, echo sounder and wind
Three Raymarine Axiom 7 displays in bracket on mast
Three Raymarine p70 autopilot control units
Raymarine autopilot (new in 2023)
Raymarine AIS700
Raymarine Quantum 4kW HD radar
Raymarine Ray240E dual VHF radio
Two steering compasses
4G/WiFi router
TV/FM antenna

GROUND TACKLE & MOORING

Modified anchor arm for better anchor release
Electric windlass with remote control in cockpit
Delta 55kg anchor
125m 14mm chain
Opacmare 2.90m hydraulic gangway
Inflatable fenders
Mooring lines

COVERS & CUSHIONS – all new in 2024

Cockpit cushions
Bimini – can be folded away into the coaming
Sprayhood – can be folded away into the coaming
Canvas covers for

- Steering wheels
- Consoles
- Winches
- Cockpit table

SAFETY

Two 6-pax life rafts with grab bag

Automatic fire extinguishing system in the engine room

Additional fire extinguishers

Electric and manual bilge pumps

Water tight bulkheads at bow and stern

Please note equipment such as life rafts, EPIRBs, fire extinguishers and flares require regular servicing and or renewal. If such equipment is left on-board as part of the sale the buyer should ensure the equipment is suited to their usage plans, assume service or replacement will be required by them after purchase and complies with any flagging requirements.

LAYOUT – CNB76

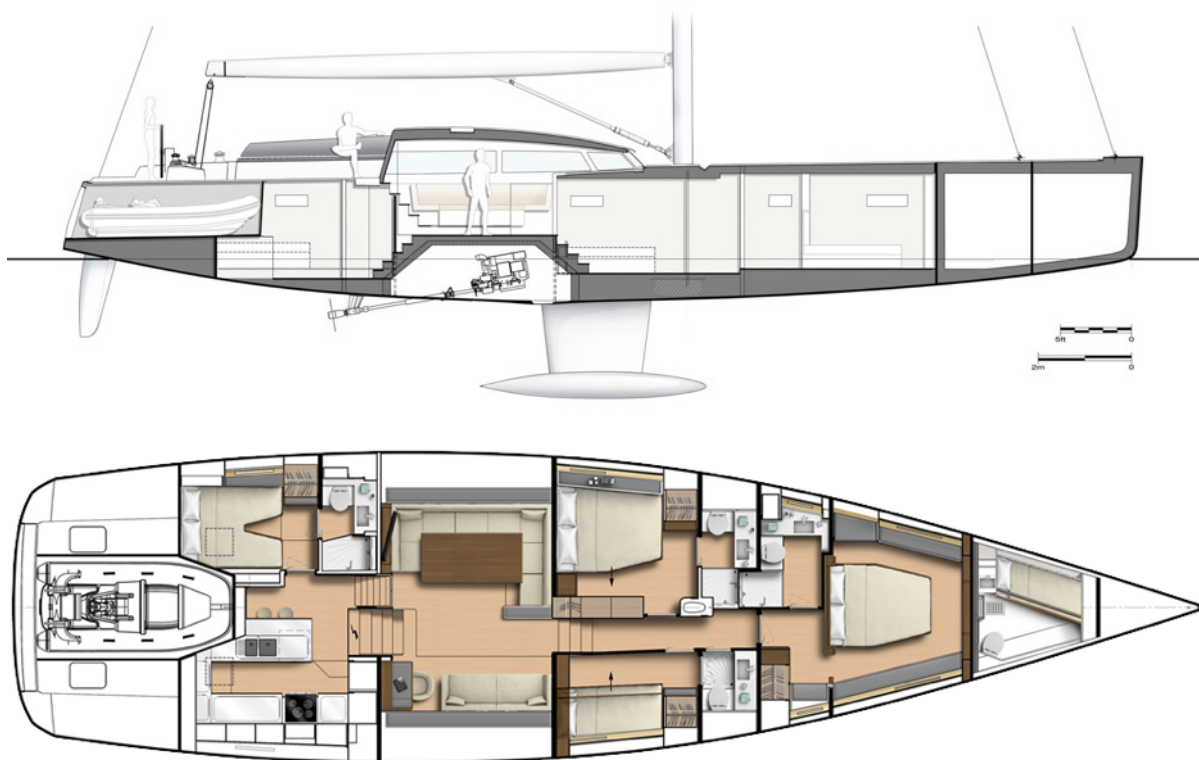

*Master cabin bed is aft facing with head against forward bulkhead

We are acting as brokers for the owner of the Vessel. The owner has provided details of the Vessel and it's inventory and these details are based on that information. The accuracy of these details cannot be guaranteed nor do they constitute part of any contract. A prospective buyer is strongly advised to have the Vessel fully surveyed by a qualified marine surveyor and to verify the particulars prior to the survey. The Vendor is not selling in the course of business unless otherwise stated. This Vessel is offered subject to prior sale, price change or withdrawal without notice.

















